



EcoLine EN/ENE 20, 35

Orbital riveting machines

- *Simple operation*
- *Easy Set-up*
- *Cost effective solution*
- *High productivity*

Optimized for profitability

Valuable investment

These simple and functional riveting machines with orbital technology offer an excellent price for performance value. The proven BalTec quality guarantees long durability, simple maintenance and a high level of productivity. Value added options such as path measuring and pressure sensors will assist in increasing profitability.

Increased productivity

Quick set-up and easy operation lead to short cycle times and help in reducing personnel costs. Process control features are available to enhance the machine efficiency and reduce reject parts.

Multipurpose design

- Slim ENE riveting units for integrating to custom assembly machines
- Complete EN machines can be used as stand-alone work stations
- Value added options such as pressure and path measuring for process control or hold-down device are available
- Easy adaptable to ever changing work conditions
- Suitable for roller forming heads



EN 35



Riveting stroke adjuster



Sensor package and riveting stroke adjuster

Technical specifications of the EcoLine machines EN 20 and EN 35

| Model | EN 20 | EN 35 |
|--------------------------|------------|------------|
| Rivet shank * max. Ø | 13 mm | 18 mm |
| Pneumatic pressure | 2–7 bar | 2–6 bar |
| Rivet force ** | 20 kN | 35 kN |
| Tool stroke | 40 mm | 50 mm |
| Riveting time | max. 5,9 s | max. 5,9 s |
| Weight (without control) | ca. 220 kg | ca. 270 kg |

* Steel 370N/mm² (St. 37), full shank rivet

** Maximum riveting force in kN

Orbital riveting heads (for EN 20 und EN 35)

| | | |
|---------------|------------|-------------|
| Tool length | 84 mm (5°) | 116 mm (3°) |
| Free height A | 28 mm | 60 mm |

EN 20

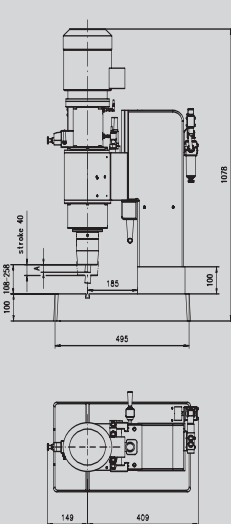

EN 35

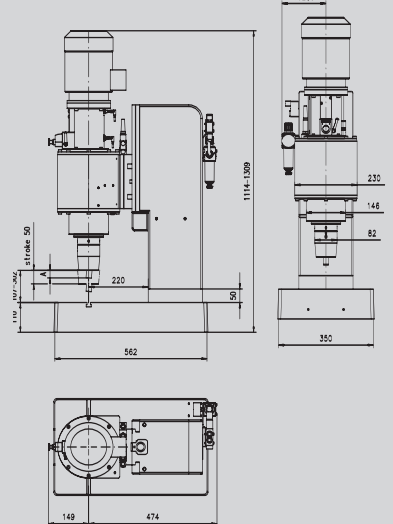

Please ask for our detailed dimensioned drawings.

Operating Features

- Standard riveting stroke adjuster
- Standard BalTec control units depending on the options chosen
- Standard riveting time adjustable
- Standard operating mode selectable
- Easy and simple maintenance
- Optional sensor package for path and/or force sensing
- Optional holding-down device

Riveting peens for every application

The comprehensive range of riveting peens available from BalTec ensures that there is a suitable riveting tool for every application.

Further information: www.baltec.com

Distributions:

Germany

BalTec Maschinenbau AG
Niederlassung Uhingen
DE-73066 Uhingen
Phone +49 (0)7161 3613 00

England/Ireland

BalTec (UK) Ltd.
Reading, Berkshire RG6, 4UT/England
Phone +44 (0)1189 311 191

North America

BalTec Corporation
130 Technology Drive
Canonsburg, PA 15317 USA
Phone +1 724-873-5757

France

BalTec France
FR-91070 Bondoufle
Phone +33 (0)1 69 47 12 00

Distribution partners:

| | |
|----------------|--------------|
| Australia | Mexico |
| Austria | Netherlands |
| Belgium | Norway |
| Bulgaria | Poland |
| China | Portugal |
| Columbia | Romania |
| Croatia | Russia |
| Czech Republic | Singapore |
| Denmark | Slovakia |
| Egypt | Slovenia |
| Finland | South Africa |
| Hungary | Spain |
| India | Sweden |
| Iran | Turkey |
| Israel | |
| Italy | |
| Japan | |
| Korea | |
| Luxembourg | |
| Malaysia | |

Your distribution partner:

BalTec Maschinenbau AG
CH-8330 Pfäffikon
Schweiz
Phone +41 (0)44 953 13 33
Fax +41 (0)44 953 13 44
E-mail: baltec@baltec.com
Internet: www.baltec.com

BalTec